

THIS DRAWING CONTAINS PROPRIETARY INFORMATION THAT IS PROPRIETARY TO YAMETER AND SHOULD NOT BE USED WITHOUT WRITTEN PERMISSION

| | | | | |
|-----|--------|--------------|------------|----------|
| REV | ECN NO | DESCRIPTION | DATE | APPROVED |
| A | - | NEW RELEASED | 2020.07.28 | MAY.YU |

Customer drawing

RoHS

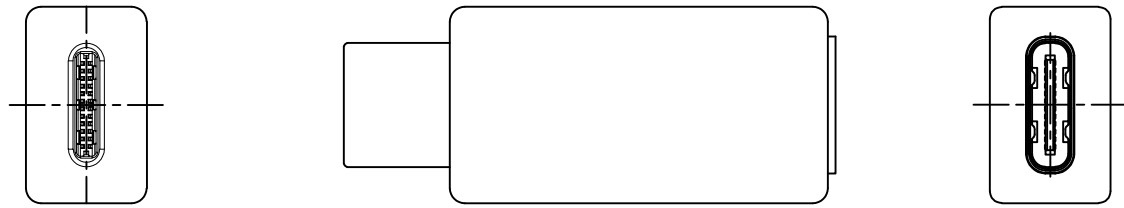

Electrical specifications:
 Use of voltage range: 30V
 Current range: 0.5A
 Temperature range: -20°C~+80°C

Material specifications
 Connector: Type-C Standard
 Overmolding: Black PVC

Electrical testing of finished cable
 100% Open / Short / Miswiring testing
 Insulation resistance: DC150V 10MΩMin
 Conductor resistance: 3Ω Max



| UNMARKED TOLERANCES | |
|---------------------|------------------|
| DIMENSIONS | TOLERANCE |
| x. | ±0.5 |
| x.x | ±0.25 |
| x.xx | ±0.15 |
| 0 to 500 | +15 / -0 |
| > 501 | +3%/-0 of length |
| ANGLES | |
| x° | ±1° |

| TITLE | |
|--|------------|
| STANDARD TYPE-C PLUG/TYPE-C SOCKET ADAPTER CONNECTOR | |
| CUSTOMER | - |
| DRAWN BY | MAY.YU |
| CHECKED BY | BILL.LEE |
| APPROVED BY | TIGER.WANG |

| | | | | | |
|----------------|--|--------------------------|--|------------------|-----|
| | | CUSTOMER PART NO. | | - | |
| | | PART NUMBER | | usb-cpcs-adapter | |
| DRAWING NUMBER | | usb-cpcs-adapter | | SIZE | REV |
| SCALE FREE | | ALL DIMENSION UNIT IN MM | | A4 | A |
| | | | | SHEET 1 OF 1 | |

